

# ONYX LITE 6KW

DUAL **MPPT** PV INPUT  
**IP65 HYBRID INVERTER**



## Unique Features



**Built-in  
CT Function**

To meet self consumption  
Application



**Reset  
ON/OFF Button**

You can Reset and ON/OFF  
manually



**Sync with  
Generator**

Auto Start



**Parallel in  
Single & Three Phase**

Parallel Function Built-in



**HMI Touch  
LCD Display**

For real time status

### Inside the Box

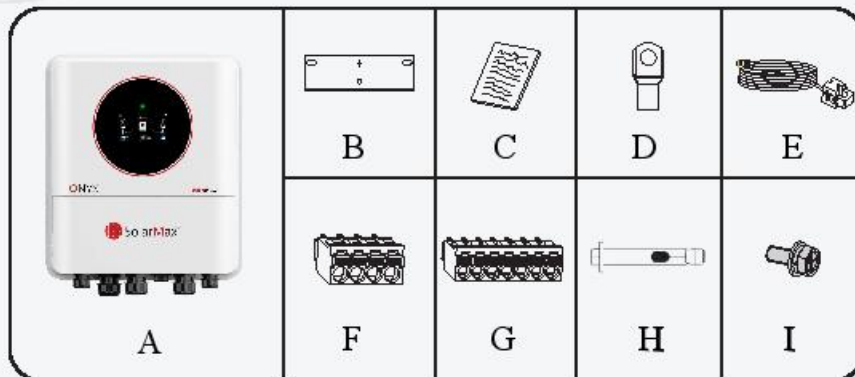

SN.	Quantity	Description
A	1	Inverter
B	1	Mounting Bracket
C	1	File Package
D	2	Battery Terminal
E	1	CT (Optional)
F	1	4-Pin Terminal
G	2	7-Pin Terminal
H	3	M10 Expansion Bolt
I	2	M4 Screws

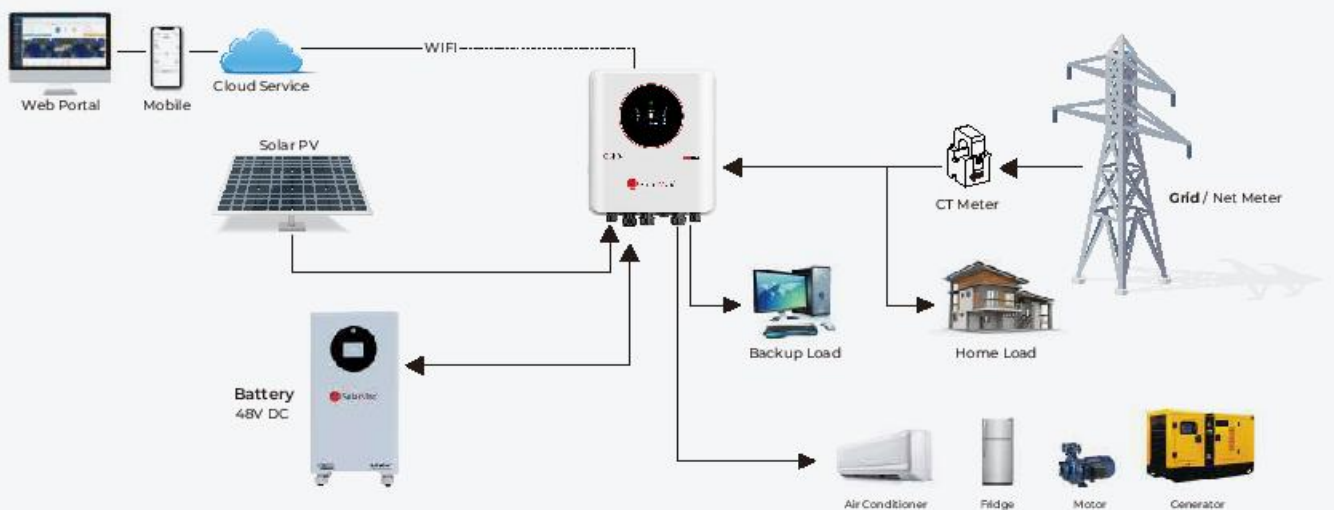

**Model****SM-ONYX-LITE-6KW****Input (PV)**

Max. PV Input Power	9,000W
Max. PV Voltage	500V
Start-up Voltage	90V
MPPT Voltage Range	70V-480V
Max. Input Current	18A / 18A
Max. Short Circuit Current	25A / 25A
Nos. of MPPT	2
String Per MPPT	1 / 1

**Input / Output (BAT)**

Battery Type	Lithium-ion / Lead-acid
Nominal Battery Voltage	48V
Battery Voltage Range	40V-60V
Max. Charge/Discharge Current	135A / 135A
Max. Charge/Discharge Power	6600W / 6600W

**AC Output**

Nominal Output Power	6,000W
Max. Output Power	6600VA
Rated AC Output Current	27.3A / 26.1A / 25.0A
Peak Output Power on PV + Battery (1min)	7200VA
Peak Output Power on PV + Battery (10s)	10,000VA
Nominal Output Voltage	220V / 230V / 240V, L+N+PE
Nominal Output Frequency	50Hz / 60Hz
Transfer Time	10ms ( Typical )
THDV	<3% (@100% R Load)

**AC Input**

Max. Input Power from Grid	9000W
Max. Input Current from Grid	41A
Rated Grid Voltage	220V / 230V / 240V, L+N+PE
Grid Input Voltage Range	176V - 264V
Rated Grid Frequency	50Hz / 60Hz
AC Frequency Range	45Hz-55Hz / 55Hz-65Hz (Adjustable)

Model

SM-ONYX-LITE-6KW

## Protection

Protection Category	Class 1
Anti-islanding Protection	Yes
AC Over Current Protection	Yes
PV/AC Over Voltage	Yes
AC Short Circuit Protection	Yes
PV Reverse Protection	Yes
Surge Protection	Type II

## General

Max. Operation Altitude	400m(>2000m Derating)
Protection Degree	IP65
Operating Temperature Range	-25°C~60°C
Relative Humidity	0~100%
Cooling	Smart Fan Cooling
Mounting	Wall Bracket
Dimensions (W*H*D)	367mm*421mm*215mm
Weight	15.5KG

## HMI & Com

Display	LED + HMI Touch LCD + Bluetooth
Communication	CAN (for BMS),RS485, CAN (for Parallel), 1*DO, 1*DI, WiFi

## Certification

Safety	IEC/EN 62109-1: 2010, IEC/EN62109-2: 2011, IEC 61683:1999, IEC 61727:2004, IEC 62116:2014,
EMC	IEC/EN 61000-6-1/2/3/4

Product specifications are subject to change without further notice.

Monitor Your Inverter **Performance**  
and Status Anytime through  
the **SolarMax Onyx** app



Scan QR Code  
to Install App



Scan QR Code  
to Install App

